

ANCRAGE DU VEHICULE  
ANCHORING OF THE VEHICLE  
VERANKERUNG DES FAHRZEUGS  
ANCORAGGIO DEL VEICOLO  
ANCLAJE DEL VEHICULO

**AN.27 (MUF7 - M8S - MT10)**  
Ou/Or/Oder/O  
**AN.27.B (SVN)**

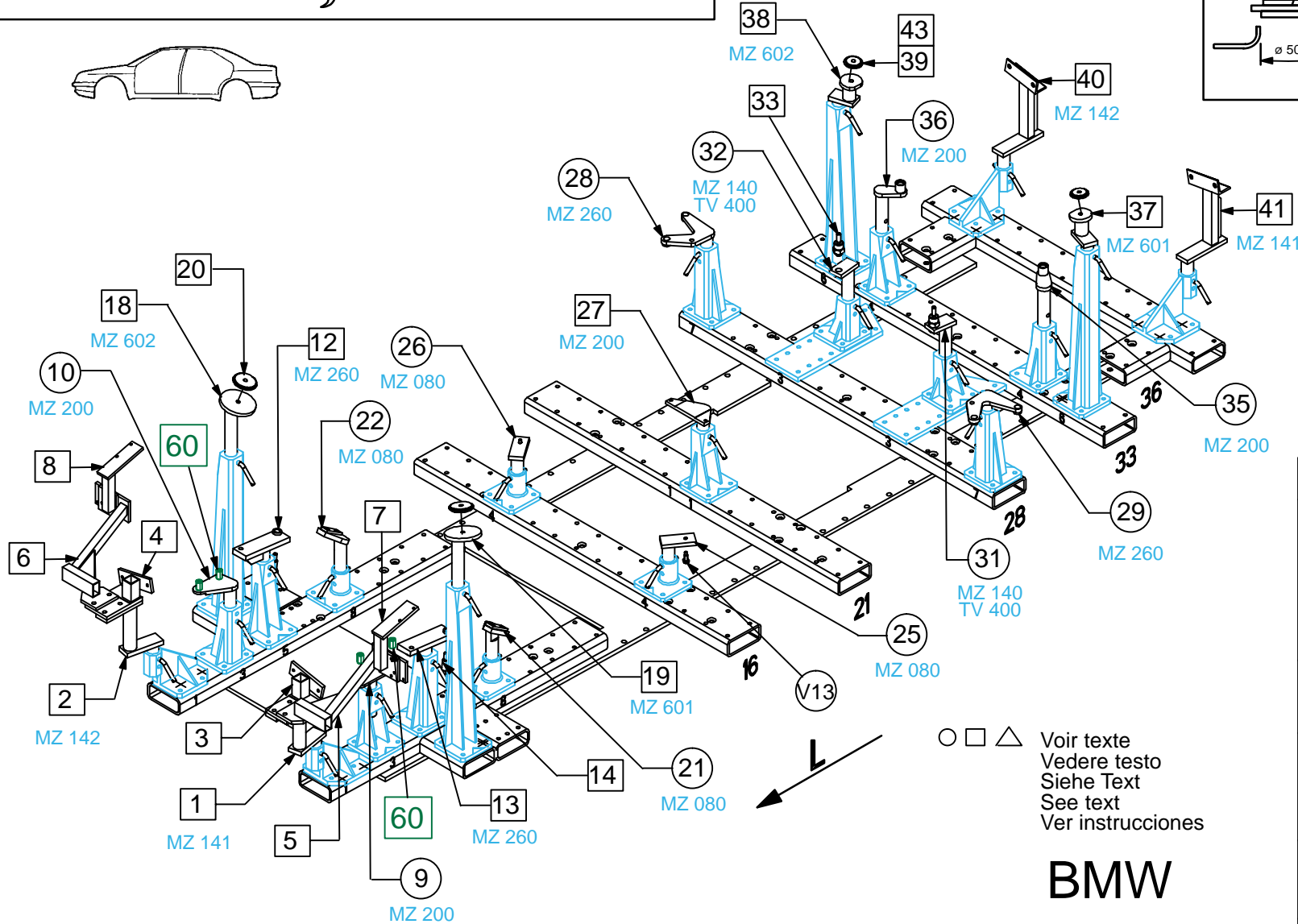
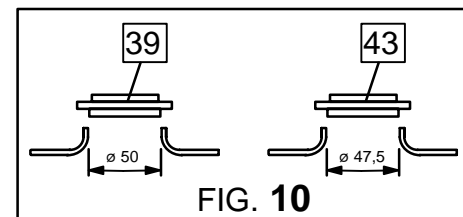

REP.	REFERENCE	PDS	NB	MZ
60	770.7060	0,1	4	
61	770.7061	2,0	1	080
62	770.7062	2,0	1	080
63	770.7063	1,6	1	080
64	770.7064	1,6	1	080
65	770.7065	0,2	2	

	M 8-16 M 12x1,50-45 M 12x1,50-70		4 2 2	
--	--	--	-------------	--

complément au  
complementary set to  
complemento al  
zusatz zu

**770.300**

**BMW**

**770.309**

9 Kg	15.03.2007	406-D-15D
------	------------	-----------

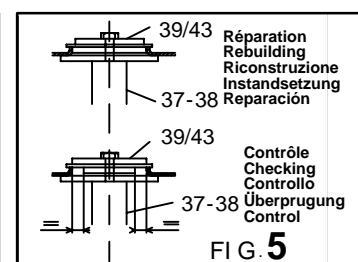
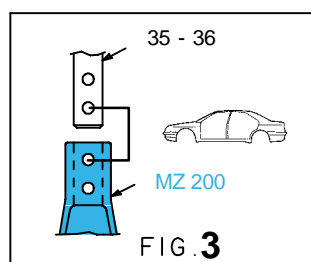
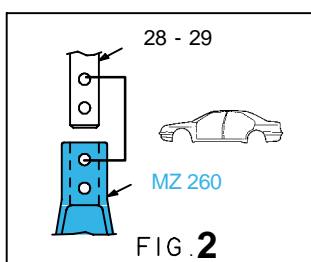
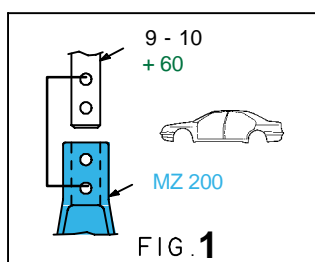
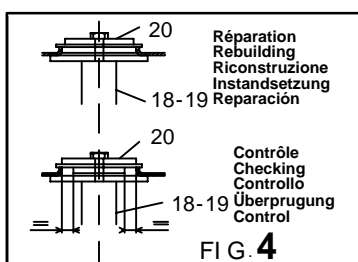
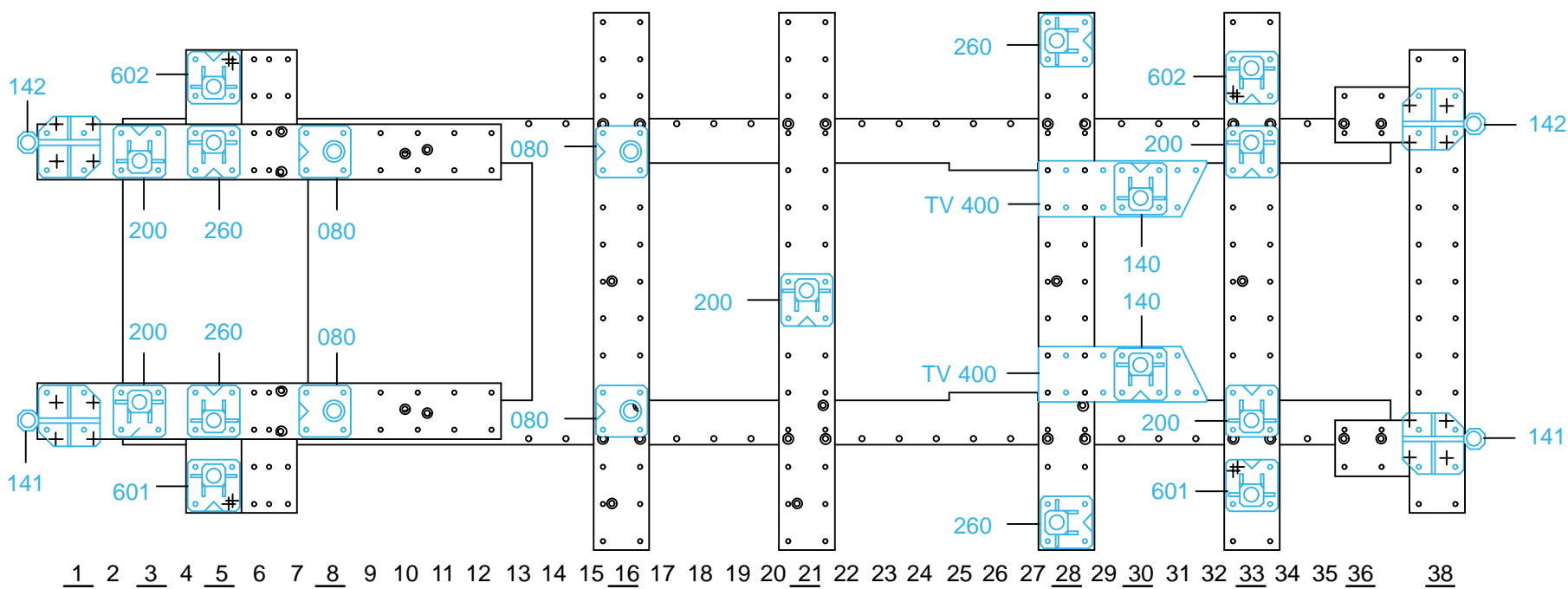

ANCRAGE DU VEHICULE  
ANCHORING OF THE VEHICLE  
VERANKERUNG DES FAHRZEUGS  
ANCORAGGIO DEL VEICOLO  
ANCLAJE DEL VEHICULO

**AN.27 (MUF7 - M8S - MT10)**  
Ou/Or/Oder/O  
**AN.27.B (SVN)**

PARE-CHOC DEPOSE  
WITHOUT BUMPER BARS  
OHNE STOßSTANGE  
SENZA PARAURTI  
PARACHOQUES DESMONTADOS

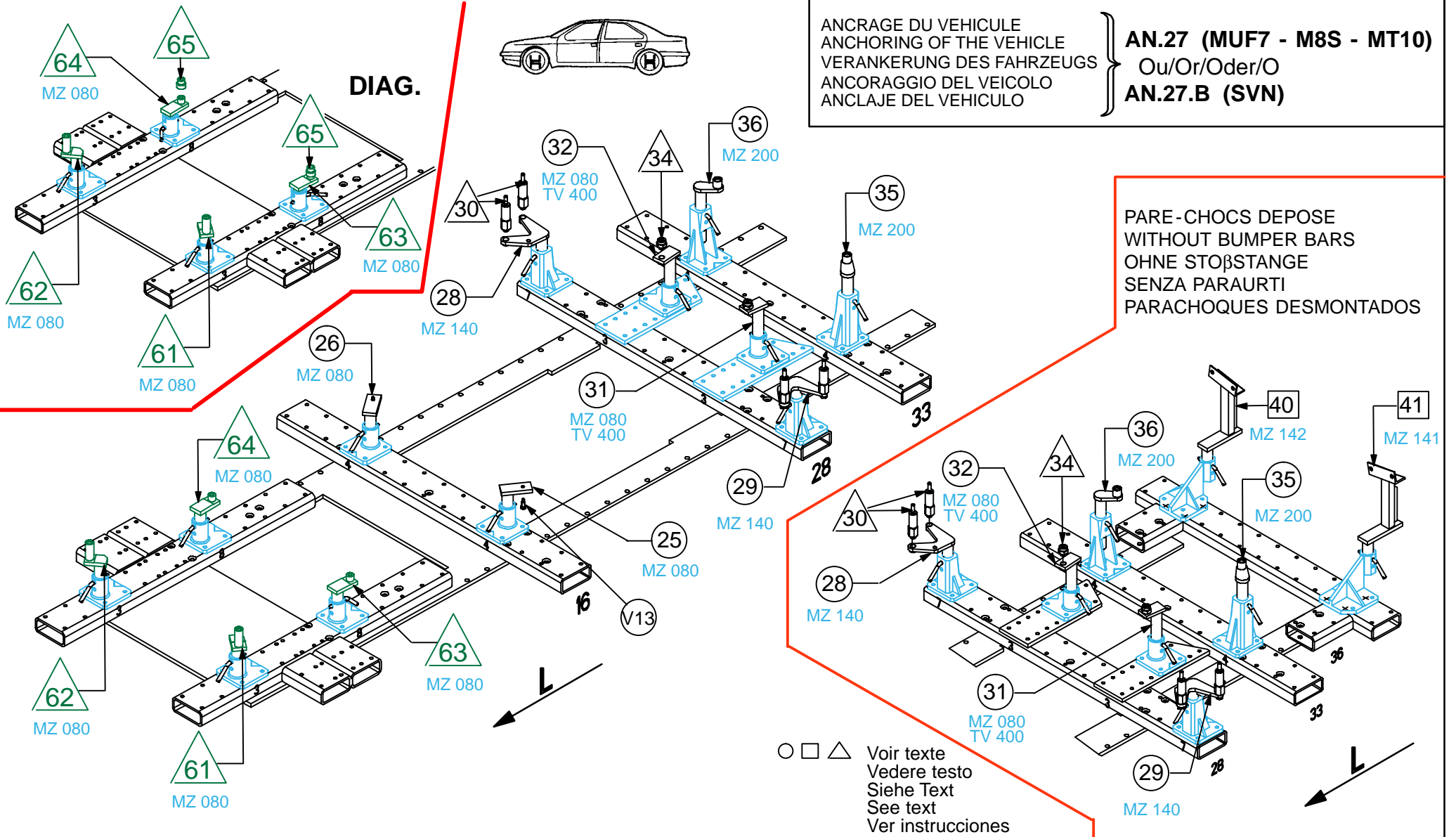

**BMW**

**770.309**

9 Kg | 10.10.2005 | 406-D-15E

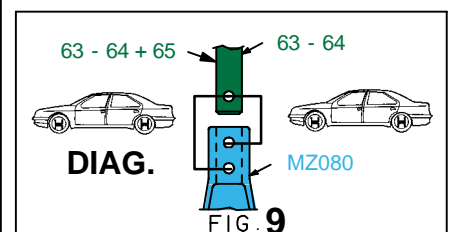
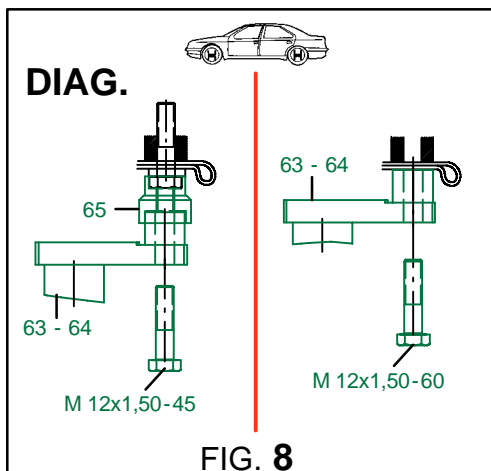
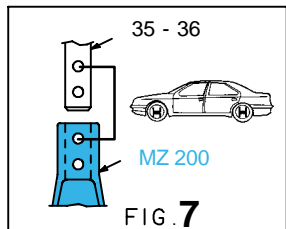
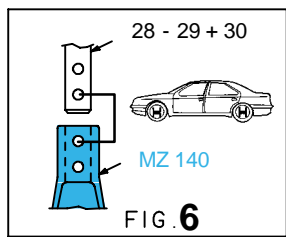
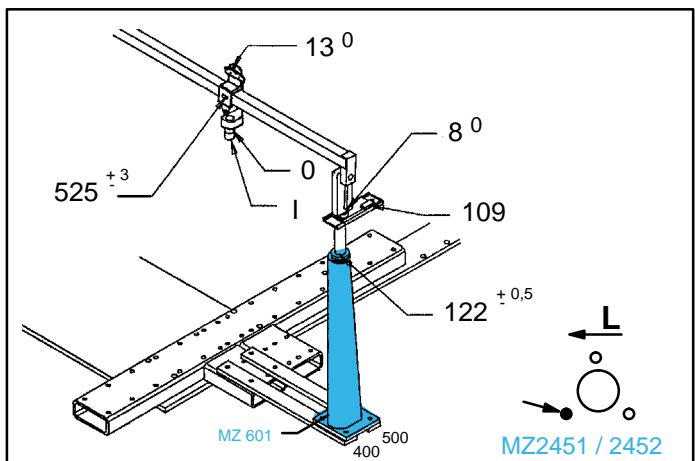
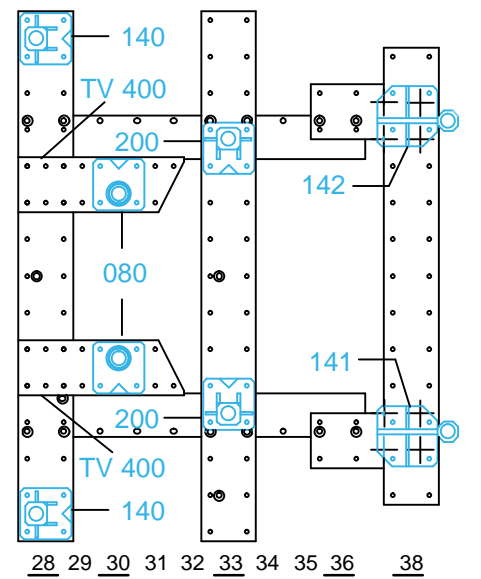
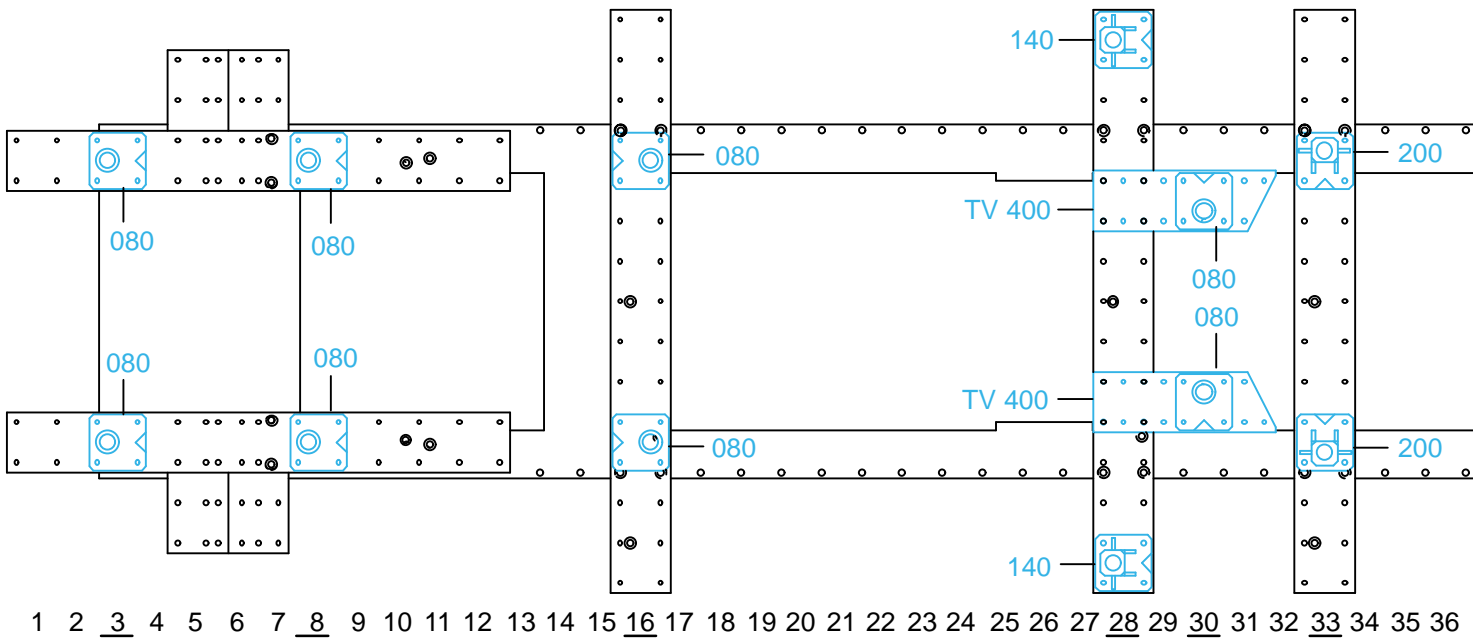

ANCRAGE DU VEHICULE } **AN.27 (MUF7 - M8S - MT10)**  
 ANCHORING OF THE VEHICLE } Ou/Or/Oder/O  
 VERANKERUNG DES FAHRZEUGS } **AN.27.B (SVN)**  
 ANCORAGGIO DEL VEICOLO }  
 ANCLAJE DEL VEHICULO }

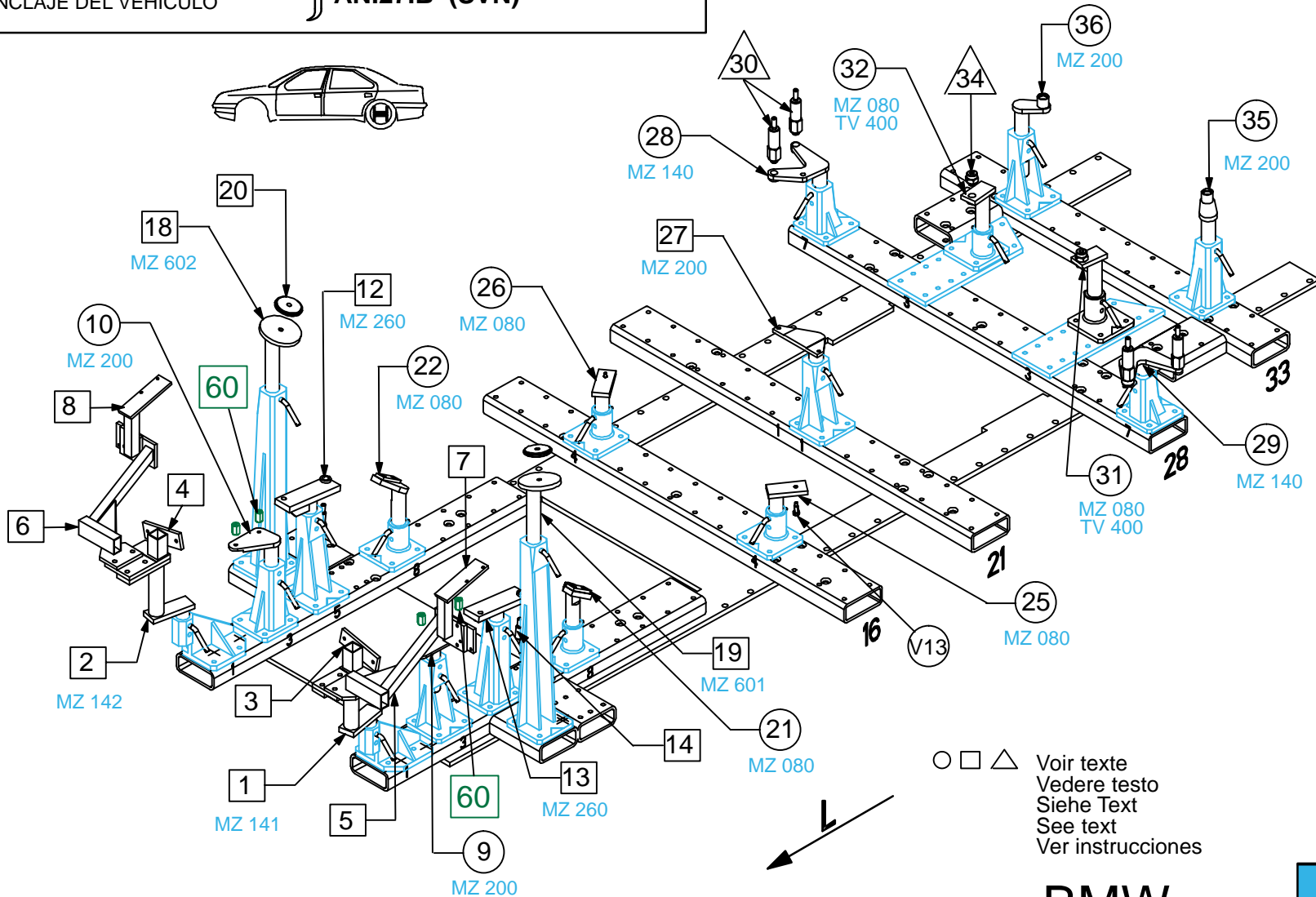

**BMW**

**770.309**

9 Kg 15.03.2007 406-D-15F

